

Working Pressure & Temperature

Max Working Pressure: 300PSI / 21 Bar
 Working Temperature: -10°C to 120°C
 Flanged X grooved Ends: ANSI B16.1 150
 BS10 Table D/E, EN1092-2
 PN10/PN16
 AWWA C 606

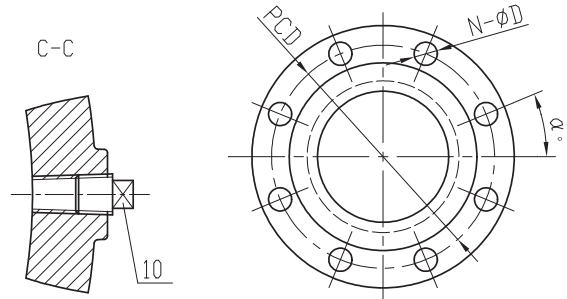

FBE coating internally and externally RAL3002.
 Grooved ends to suit ANSI/BS standard pipe.



Material List

Name	Material
Body	Ductile Iron ASTM A536 65-45-12
Bolt	Gr 8.8
Washer	Gr 8.8
Washer	Gr 8.8
Cover	Ductile Iron ASTM A536 65-45-12
Screen	Stainless Steel SS304
Plug	Carbon Steel Q235+Zn
Plug Seal	45#+EPDM
O Ring	EPDM
Test Screw	ASTM B16

Size (mm)	Measured loss at 15fps (4.6m/s)
50 (2")	7.22 psi
65 (2.5")	5.89 psi
80 (3")	8.24 psi
100 (4")	5.88 psi
125 (5")	7.63 psi
150 (6")	4.82 psi
200 (8")	5.83 psi
250 (10")	7.25 psi
300 (12")	5.73 psi

Dimensions (mm)

DN	L	H	H1	ØD	ANSI 150					Weight
					PCD	N-ØD	a°	ØD1	F	
50 (2")	203 (7.99")	130 (5.20")	195 (7.68")	60.3 (2.37")	120.7	4-Ø19	45	92.1	2	7.55kg
65 (2.5")	254 (10.00")	158 (6.22")	240 (9.45")	73.0 (2.87") 76.1 (3")	139.7	4-Ø19	45	104.8	2	13.05kg
80 (3")	260 (10.24")	175 (6.89")	270 (10.63")	88.9 (3.50")	152.4	4-Ø19	45	127	2	17kg
100 (4")	308 (12.13")	202 (7.95")	320 (12.60")	114.3 (4.50")	190.5	8-Ø19	22.5	157.2	2	26kg
125 (5")	398 (15.67")	290 (11.42")	425 (16.73")	139.7 (5.5") 141.3 (5.56")	215.9	8-Ø22.2	22.5	185.7	2	32kg
150 (6")	472 (18.58")	334 (13.15")	495 (19.49")	165.1 (6.5") 168.3 (6.63")	241.3	8-Ø22.2	22.5	215.9	2	55.6kg
200 (8")	550 (21.65")	391 (15.39")	570 (22.44")	219.1 (8.63")	298.5	8-Ø22.2	22.5	269.9	2	93.6kg
250 (10")	654 (25.75")	460 (18.11")	700 (27.56")	273 (10.75")	361.9	12-Ø25.4	15	323.8	2	132kg
300 (12")	762 (30.00")	590 (23.23")	840 (33.07")	323.9 (12.75")	431.8	12-Ø25.4	15	381	2	206kg

Ordering Information

Description	Size (mm)	Part Number
RASCO Y Strainer Flanged/Grooved ANSI 150	50 (2")	7U99002129
RASCO Y Strainer Flanged/Grooved ANSI 150	65 (2.5")	7U99002130
RASCO Y Strainer Flanged/Grooved ANSI 150	80 (3")	7U99002131
RASCO Y Strainer Flanged/Grooved ANSI 150	100 (4")	7U99002132
RASCO Y Strainer Flanged/Grooved ANSI 150	125 (5")	7U99002133
RASCO Y Strainer Flanged/Grooved ANSI 150	150 (6")	7U99002134
RASCO Y Strainer Flanged/Grooved ANSI 150	200 (8")	7U99002135
RASCO Y Strainer Flanged/Grooved ANSI 150	250 (10")	7U99002136
RASCO Y Strainer Flanged/Grooved ANSI 150	300 (12")	7U99002137

Mesh

NPS	Screen Hole Diameter (mm)	Open Area
2	3.3	21.3%
2.5	3.3	23.2%
3	3.3	23.9%
4	4.78	24.8%
5	4.78	24.1%
6	6	22.6%
8	6.4	24.4%
10	6.4	24.6%
12	6.4	24.9%