

Reliable®

Model FLX1 Flexible Coupling

cULus Listed, FM Approved
300 psi (20.7 bar)

FLX1 Flexible Coupling Technical Data

Operating Specifications
Maximum Working Pressure:
 300 psi (20.7 bar)
Operating Temperature
 -30 °F to 230 °F (-34 °C to 110 °C)

Material Specifications

Housings: ASTM A536 Grade 65-45-12 Ductile Iron
Gasket: Pre-lubricated Grade E EPDM

Design Specification

Groove: AWWA-C606

Bolt Specification:
 SAE J429 Grade 5

Available Finishes

Housing:

Standard orange paint
 Hot dipped galvanized (ASTM A-153)

Bolts and Nuts:

Zinc Electroplating

Listings and Approvals

cULus Listed
 FM Approved



FLX1 Flexible Coupling Dimensions

Figure 1

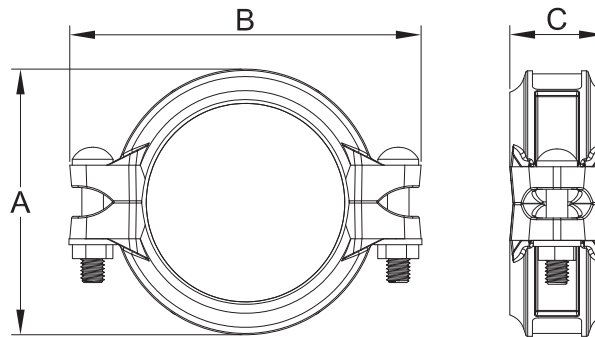

Table A

Nominal Size in (mm)	Pipe O.D. in (mm)	Max. End Load Lbs (KN)	Pipe End Gap in (mm)	Bolts Size x Length in	Angular Movement from Centerline		Dimensions			Weight lb (kg)
					Per Coupling Deg.	Per Pipe in/ft (mm/m)	A in (mm)	B in (mm)	C in (mm)	
1 (25)	1.315 (33.7)	405 (1.8)	1/16 (1.6)	3/8 x 1-1/2	2.75°	0.58 (48)	2-3/16 (55)	3-13/16 (97)	1-3/4 (45)	0.99 (0.45)
1-1/4 (32)	1.660 (42.2)	656 (2.92)	1/16 (1.6)	3/8 x 1-3/4	2.17°	0.46 (38)	2-1/2 (64)	4-1/4 (108)	1-3/4 (45)	1.10 (0.50)
1-1/2 (40)	1.900 (48.3)	852 (3.79)	1/16 (1.6)	3/8 x 1-3/4	1.9°	0.4 (33)	2-3/4 (69)	4-1/2 (114)	1-3/4 (45)	1.17 (0.53)
2 (50)	2.375 (60.3)	1327 (5.91)	1/16 (1.6)	3/8 x 2-1/8	1.52°	0.32 (27)	3-5/16 (84)	4-7/8 (124)	1-13/16 (46)	1.50 (0.68)
2-1/2 (65)	2.875 (73.0)	1945 (8.66)	1/16 (1.6)	3/8 x 2-1/8	1.25°	0.26 (22)	3-7/8 (98)	5-3/8 (137)	1-13/16 (46)	1.85 (0.84)
3 (80)	3.500 (88.9)	2885 (12.84)	1/16 (1.6)	3/8 x 2-1/8	1.03°	0.22 (18)	4-1/2 (114)	6-1/8 (156)	1-13/16 (46)	2.16 (0.98)
4 (100)	4.500 (114.3)	4769 (21.22)	1/8 (3.2)	1/2 x 2-5/8	1.6°	0.34 (28)	5-9/16 (142)	7-7/16 (189)	2 (50)	3.02 (1.37)
6 (150)	6.625 (168.3)	10340 (46)	1/8 (3.2)	1/2 x 2-5/8	1.08°	0.23 (19)	7-13/16 (198)	9-7/8 (251)	2 (50)	4.63 (2.10)
8 (200)	8.625 (219.1)	17524 (77.97)	1/8 (3.2)	5/8 x 3-1/8	0.83°	0.18 (15)	10-1/16 (256)	12-7/16 (316)	2-3/8 (60)	8.27 (3.75)
10 (250)	10.750 (273.0)	27206 (121.05)	1/8 (3.2)	3/4 x 3-1/2	0.83°	0.14 (12)	12-9/16 (319)	15-1/2 (393)	2-1/2 (64)	14.22 (6.45)
12 (300)	12.750 (323.9)	38297 (170.39)	1/8 (3.2)	3/4 x 4-1/3	0.83°	0.12 (10)	14-3/4 (374)	17-13/16 (453)	2-1/2 (65)	18.95 (8.55)

FLX1 Pipe Compatibility

Table B

Nominal Size in (mm)	Groove Type	Pipe	Approvals
1 (25)	Cut, Rolled	40	cULus, FM
	Rolled	10	FM
1-1/4 (32)	Cut, Rolled	40	cULus, FM
		10	cULus, FM
	Rolled	Mega-Flow Schedule 7	cULus, FM
		Eddy Flow Schedule 7	cULus, FM
1-1/2 (40)	Cut, Rolled	40	cULus, FM
		10	cULus, FM
	Rolled	Fire-Flo Schedule 7	cULus, FM
		Mega-Flow Schedule 7	cULus, FM
		Eddy Flow Schedule 7	cULus, FM
2 (50)	Cut, Rolled	40	cULus, FM
		10	cULus, FM
	Rolled	Fire-Flo Schedule 7	cULus, FM
		Mega-Flow Schedule 7	cULus, FM
		Eddy Flow Schedule 7	cULus, FM
		Hydroflow Schedule 7	cULus, FM
2-1/2 (65)	Cut, Rolled	40	cULus, FM
		10	cULus, FM
	Rolled	Fire-Flo Schedule 7	cULus, FM
		Mega-Flow Schedule 7	cULus, FM
		Eddy Flow Schedule 7	cULus, FM
		Hydroflow Schedule 7	cULus, FM
3 (80)	Cut, Rolled	40	cULus, FM
		10	cULus, FM
	Rolled	Fire-Flo Schedule 7	cULus, FM
		Mega-Flow Schedule 7	cULus, FM
		Eddy Flow Schedule 7	cULus, FM
		Hydroflow Schedule 7	cULus, FM
4 (100)	Cut, Rolled	40	cULus, FM
		10	cULus, FM
	Rolled	Fire-Flo Schedule 7	cULus, FM
		Mega-Flow Schedule 7	cULus, FM
		Eddy Flow Schedule 7	cULus, FM
		Hydroflow Schedule 7	cULus, FM
6 (150)	Cut, Rolled	40	cULus, FM
		10	cULus, FM
	Rolled	Mega-Flow Schedule 7	cULus, FM

FLX1 Pipe Compatibility (cont.)

Table B

Nominal Size in (mm)	Groove Type	Pipe	Approvals
8 (200)	Cut, Rolled	40	cULus, FM
	Rolled	10	cULus
		0.188 in. wall	FM
10 (250)	Cut, Rolled	40	cULus, FM
	Rolled	10	cULus
		0.188 in. wall	FM
12 (300)	Cut, Rolled	40	cULus, FM
	Rolled	ASME B36.10M-10	cULus
		0.188 in. wall	FM

Notes:

1. 10 refers to Schedule 10 steel pipe in accordance with NFPA 13.
2. 40 refers to Schedule 40 steel pipe in accordance with NFPA 13.
3. Fire-Flo Schedule 7 refers to Youngstown Tube Schedule 7 pipes.
4. Mega-Flow Schedule 7 refers to Listed Mega-Flow steel Pipe manufactured by Wheatland Tube Co.
5. Eddy Flow Schedule 7 refers to Listed Eddy Flow steel pipe manufactured by Bull Moose Tube Co.
6. Hydroflow Schedule 7 refers to Listed Nucor Hydroflow steel pipe manufactured by Nucor Tubular Products Inc.