

TRIM PART NUMBER TABLE		
VALVE SIZE	TRIM PART NUMBERS	
	LOOSE	SEGMENTALLY ASSEMBLED
2"	6508000001	6508000011
2-1/2", 3" & 76MM	6508000002	6508000012
4", 6" & 165MM	6508000003	6508000013

FULLY ASSEMBLED PART NUMBER CODE

65080XYZ00

(SEE TABLES FOR "X", "Y" & "Z" CODES)

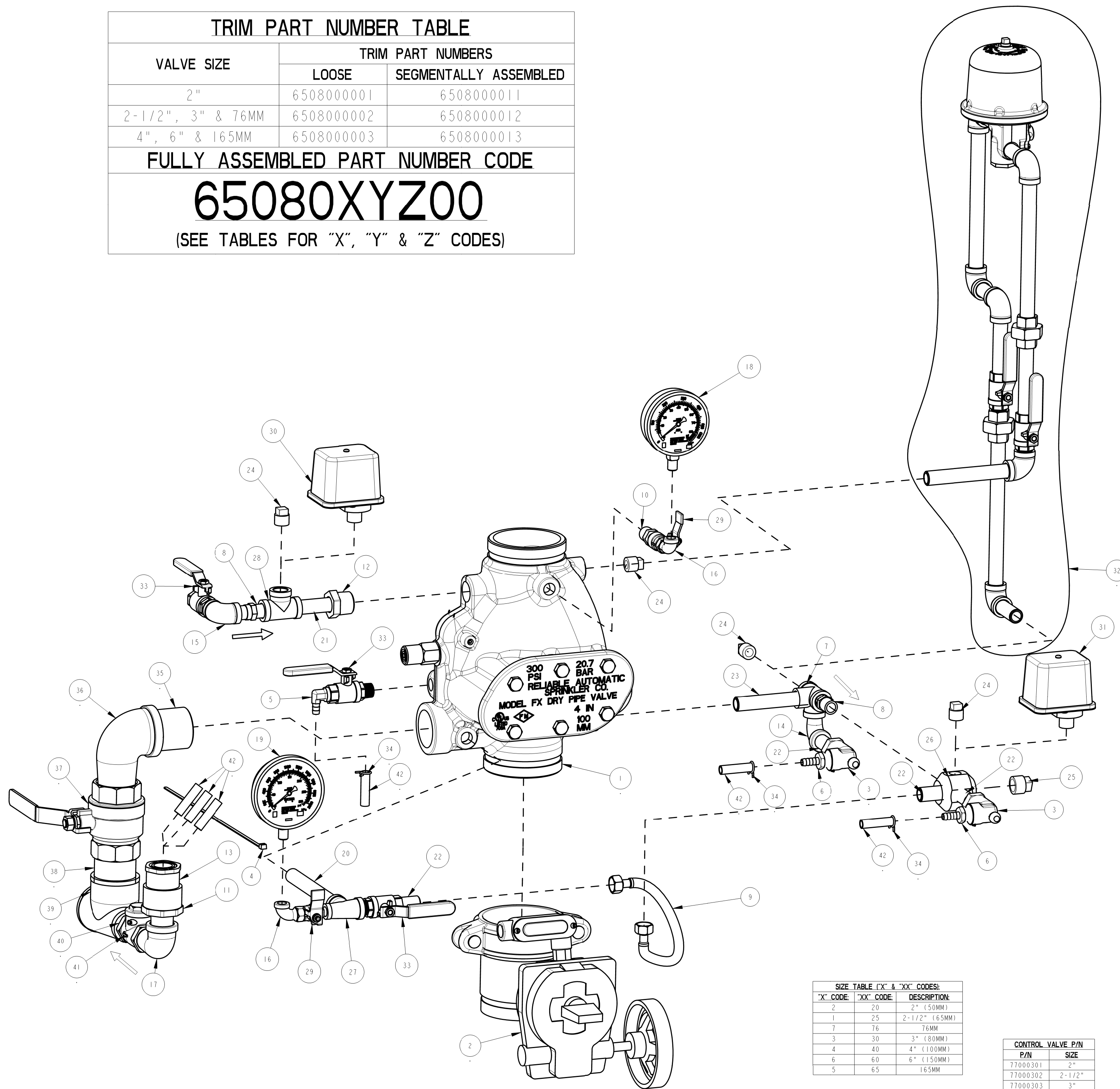

MODEL FX 2", 2-1/2", 3", 4", & 6" DRY PIPE VALVE
CA-327 P/N 89241298 REV. A

SIZE TABLE ("X" & "Y" CODES)

"X" CODE	"Y" CODE	DESCRIPTION
2	20	2" (50MM)
1	25	2-1/2" (65MM)
7	76	76MM
3	30	3" (80MM)
4	40	4" (100MM)
6	60	6" (150MM)
5	65	165MM

CONTROL VALVE P/N

P/N	SIZE
77000301	2"
77000302	2-1/2"
77000303	3"
77000304	4"
77000306	6"

END CONNECTION AND COLOR TABLE ("Y" CODE)

"Y" CODE	DESCRIPTION
0	BLACK, GROOVE/GROOVE
1	BLACK, FLANGE/GROOVE, CLASS 150
2	BLACK, FLANGE/GROOVE, BS-E
3	BLACK, FLANGE/GROOVE, PN 16
4	BLACK, FLANGE/FLANGE, CLASS 150
5	BLACK, FLANGE/FLANGE, BS-E
6	BLACK, FLANGE/FLANGE, PN 16
7	RED, GROOVE/GROOVE
8	RED, FLANGE/GROOVE, CLASS 150
9	RED, FLANGE/GROOVE, BS-E
A	RED, FLANGE/GROOVE, PN 16
B	RED, FLANGE/FLANGE, CLASS 150
C	RED, FLANGE/FLANGE, BS-E
E	RED, FLANGE/FLANGE, PN 16

CONTROL VALVE AND ACCELERATOR TABLE ("Z" CODE)

"Z" CODE	DESCRIPTION
0	W/O CONTROL VALVE, W/O ACCELERATOR
1	W/ CONTROL VALVE, W/O ACCELERATOR
2	W/ 2 CONTROL VALVES, W/O ACCELERATOR
3	W/O CONTROL VALVE, W/ ACCELERATOR
4	W/ CONTROL VALVE, W/ ACCELERATOR
5	W/ 2 CONTROL VALVE, W/ ACCELERATOR

ITEM NO.	PART NO.	DESCRIPTION	REMARKS	QTY.
43	95516915	PERMA-LOK	NOT SHOWN	A/R
42	96686756	TUBING, PVC, 3/8" ID, 6FT LONG		1
41	98840145	SWING CHECK VALVE, 1" NPT		1
40	98543213	NIPPLE, STEEL, GALV., 1" X CLOSE		1
	96606653	TEE, GALV., 2" X 1" X 2"	4" & 6" VERSIONS	
39	96606652	TEE, GALV., 1-1/4" X 1" X 1-1/4"	2-1/2" & 3" VERSIONS	1
	96606651	TEE, GALV., 1" X 1" X 3/4"	2" VERSIONS	
	98543238	NIPPLE, STEEL, GALV., 2" X CLOSE	4" & 6" VERSIONS	
38	98543285	NIPPLE, STEEL, GALV., 1-1/4" X CLOSE	2-1/2" & 3" VERSIONS	1
	98543279	NIPPLE, STEEL, GALV., 3/4" X CLOSE	2" VERSIONS	
	98840136	VALVE, BALL, 2"	4" & 3" VERSIONS	
37	98840137	VALVE, BALL, 1-1/4"	2-1/2" & 3" VERSIONS	1
	98840108	VALVE, BALL, 3/4"	2" VERSIONS	
	98174415	ELBOW, STREET, 2" MALL IRON, GALV.	4" & 6" VERSIONS	
36	98174410	ELBOW, STREET, 1-1/4" MALL IRON, GALV.	2-1/2" & 3" VERSIONS	1
	98174413	ELBOW, STREET, 3/4" MALL IRON, GALV.	2" VERSIONS	
	98543299	NIPPLE, STEEL, GALV., 2" X 2-1/2"	4" & 6" VERSIONS	
35	98543297	NIPPLE, STEEL, GALV., 1-1/4" X 2"	2-1/2" & 3" VERSIONS	2
	98543232	NIPPLE, STEEL, GALV., 3/4" X 2"	2" VERSIONS	
34	95306255	CLAMP, HOSE, 1/2" CONSTANT TENSION, ZINC		3
33	9884011A	VALVE, BALL, 1/2" NPTF X 1/2" NPTM		3
32	650120001A	ASSEMBLY, TRIM, ACCELERATOR	OPTIONAL	1
31	6990006382	SWITCH, PRESSURE (PS10-2)		1
30	6990006381	SWITCH, PRESSURE (PS40-2)		1
29	98840237	VALVE, BALL, 1/4" NPTF X 1/4" NPTM		2
28	98761651	TEE, GLVN., 1/2"		1
27	98761649	TEE, GLVN., 1/2" X 1/4" X 1/2"		1
26	98751005	FITTING, MULTIPOINT, 3/4x1/2x1/2x1/2x1/2		1
25	98614401	PLUG, IRON, SQ. HD., 3/4"		1
24	98604406	PLUG, IRON, SQ. HD., 1/2"		4
23	98543228	NIPPLE, STEEL, GALV., 1/2" X 4-1/2"		1
22	98543223	NIPPLE, STEEL, GALV., 1/2" X 1-1/2"		4
21	98543210	NIPPLE, STEEL, GALV., 1/2" X 2-1/2"		1
20	98543203	NIPPLE, STEEL, GALV., 1/2" X 7"		1
19	98248001	GAUGE, WATER PRESSURE (0-300 PSI)		1
18	98248000	GAUGE, AIR PRESSURE (0-80 PSI)		1
17	98174416	ELBOW, STREET, 1", GALV.		1
16	98174408	ELBOW, STREET, 1/4", GALV.		2
15	98174401	ELL, 1/2", MALL IRON, GALV.		1
14	98174400	ELBOW, STREET, 1/2", GALV.		1
13	98050006	ADAPTER, PVC, 1-1/2" SOCKET X 3/4" SOCKET		1
12	98048027	BUSHING, REDUCER, 1" X 1/2", GALV.		1
11	98048017	ADAPTER, PVC, 1-1/2" SOCKET X 1" NPT		1
10	98048000	BUSHING, REDUCER, 1/2" X 1/4", GALV.		1
9	96920912	FLEX LINE, 12"		1
8	96816904	VALVE, CHECK, 1/2"		2
7	96626902	TEE, SIDE OUTLET, 1/2", 90°, GALV.		1
6	92056810	CONNECTOR, 3/8" ID TUBE X 1/2" NPT		2
5	92056704	CONNECTOR, ELBOW, 3/8" ID TUBE X 1/2" NPT		1
4	89141112	TIE, RETAINING		1
3	78653800	ASSEMBLY, BALL DRIP, 1/2"		2
2	SEE TABLE	ASSEMBLY, CONTROL VALVE		1 OR 2
1	61010XX60Y	ASSEMBLY, VALVE		1