

# Clevis Hangers

## Model #400

### Standard Clevis Hanger

**APPLICATION:** Recommended for the support of stationary non-insulated pipe lines.

**NOTE:** Available with a HD finish.

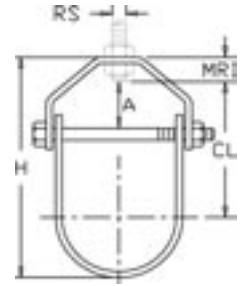

7

Part No.	Pipe Size	H	CL	RS	MRI	A	Max. Recom. Load (lbs)	Finish*
4000050PL	1/2	2-1/2	1-7/16	3/8	9/16	3/8	610	PL
4000050RO	1/2	2-1/2	1-7-16	3/8	9/16	3/8	610	RO
4000075PL	3/4	2-3/4	1-9/16	3/8	9/16	3/8	610	PL
4000075RO	3/4	2-3/4	1-9/16	3/8	9/16	3/8	610	RO
4000100PL	1	3	1-11/16	3/8	9/16	3/8	610	PL
4000100RO	1	3	1-11/16	3/8	9/16	3/8	610	RO
4000125PL	1-1/4	3-3/8	1-13/16	3/8	9/16	3/8	610	PL
4000125RO	1-1/4	3-3/8	1-13/16	3/8	9/16	3/8	610	RO
4000150PL	1-1/2	3-7/8	2-3/16	3/8	9/16	11/16	610	PL
4000150RO	1-1/2	3-7/8	2-3/16	3/8	9/16	11/16	610	RO
4000200PL	2	4-7/8	2-15/16	3/8	9/16	1-1/8	610	PL
4000200RO	2	4-7/8	2-15/16	3/8	9/16	1-1/8	610	RO
4000250PL	2-1/2	6-1/8	3-3/4	1/2	3/4	1-3/16	1130	PL
4000250RO	2-1/2	6-1/8	3-3/4	1/2	3/4	1-3/16	1130	RO
4000300PL	3	6-3/4	4-1/8	1/2	3/4	1-5/16	1130	PL
4000300RO	3	6-3/4	4-1/8	1/2	3/4	1-5/16	1130	RO
4000350PL	3-1/2	6-11/16	3-11/16	1/2	3/4	1-7/16	1130	PL
4000350RO	3-1/2	6-11/16	3-11/16	1/2	3/4	1-7/16	1130	RO
4000400PL	4	8-1/8	4-13/16	5/8	15/16	1-7/16	1430	PL
4000400RO	4	8-1/8	4-13/16	5/8	15/16	1-7/16	1430	RO
4000500PL	5	9-5/8	5-11/16	5/8	15/16	1-3/4	1430	PL
4000500RO	5	9-5/8	5-11/16	5/8	15/16	1-3/4	1430	RO
4000600PL	6	11-1/4	6-11/16	3/4	1-1/16	2-3/16	1940	PL
4000600RO	6	11-1/4	6-11/16	3/4	1-1/16	2-3/16	1940	RO
4000800PL	8	14-3/4	8-15/16	7/8	1-3/16	3-1/4	2000	PL
4000800RO	8	14-3/4	8-15/16	7/8	1-3/16	3-1/4	2000	RO
4001000PL	10	15-3/4	8-5/8	7/8	1-5/16	2-1/8	3600	PL
4001000RO	10	15-3/4	8-5/8	7/8	1-5/16	2-1/8	3600	RO
4001200PL	12	18-7/8	10-15/16	7/8	1-5/16	2-1/2	3800	PL
4001200RO	12	18-7/8	10-15/16	7/8	1-5/16	2-1/2	3800	RO
4001400PL	14	19-3/4	10-15/16	1	1-9/16	2-3/8	4200	PL
4001400RO	14	19-3/4	10-15/16	1	1-9/16	2-3/8	4200	RO
4001600PL	16	22	12-3/16	1	1-9/16	2-7/16	4600	PL
4001600RO	16	22	12-3/16	1	1-9/16	2-7/16	4600	RO
4001800PL	18	25-1/2	14-1/2	1-1/8	1-3/4	3-7/16	4800	PL
4001800RO	18	25-1/2	14-1/2	1-1/8	1-3/4	3-7/16	4800	RO
4002000PL	20	28-1/4	15-15/16	1-1/4	1-15/16	3-11/16	4800	PL
4002000RO	20	28-1/4	15-15/16	1-1/4	1-15/16	3-11/16	4800	RO
4002400PL	24	30-1/4	17-13/16	1-1/4	1-15/16	3-13/16	4800	PL
4002400RO	24	30-1/4	17-13/16	1-1/4	1-15/16	3-13/16	4800	RO
4003000PL	30	39-5/16	22	1-1/4	1-15/16	4-13/16	6000	PL

**Conforms With:** Federal Specification **WW-H-171** (Type 1), Manufacturers Standardization Society **ANSI/MSS-SP-58** (Type 1); install in accordance with **ANSI/MSS-SP-69**.



All dimensions are in inches unless otherwise noted.  
\*See page 2 for finish and material descriptions. All material is Carbon Steel unless otherwise noted.

# Clevis Hangers

## Model #401 Galvanized Clevis Hanger

**APPLICATION:** Recommended for the support of stationary, non-insulated pipe lines.



(2-1/2 thru 8 only)

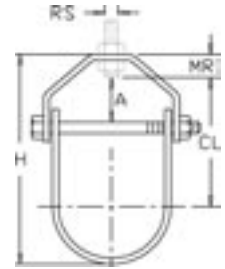

Part No.	Pipe Size	H	CL	RS	MRI	A	Max. Recom. Load (lbs)	Finish*
4010050EG	1/2	2-1/2	1-7/16	3/8	9/16	3/8	610	EG
4010075EG	3/4	2-3/4	1-9/16	3/8	9/16	3/8	610	EG
4010100EG	1	3	1-11/16	3/8	9/16	3/8	610	EG
4010125EG	1-1/4	3-3/8	1-13/16	3/8	9/16	3/8	610	EG
4010150EG	1-1/2	3-7/8	2-3/16	3/8	9/16	11/16	610	EG
4010200EG	2	4-7/8	2-15/16	3/8	9/16	1-1/8	610	EG
4010250EG	2-1/2	6-1/8	3-3/4	1/2	3/4	1-3/16	1130	EG
4010300EG	3	6-3/4	4-1/8	1/2	3/4	1-5/16	1130	EG
4010350EG	3-1/2	6-11/16	3-11/16	1/2	3/4	1-7/16	1130	EG
4010400EG	4	8-1/8	4-13/16	5/8	15/16	1-7/16	1430	EG
4010500EG	5	9-5/8	5-11/16	5/8	15/16	1-3/4	1430	EG
4010600EG	6	11-1/4	6-11/16	3/4	1-1/16	2-3/16	1940	EG
4010800EG	8	14-3/4	8-15/16	7/8	1-3/16	3-1/4	2000	EG
4011000EG	10	15-3/4	8-5/8	7/8	1-5/16	2-1/8	3600	EG
4011200EG	12	18-7/8	10-15/16	7/8	1-5/16	2-1/2	3800	EG
4011400EG	14	19-3/4	10-15/16	1	1-9/16	2-3/8	4200	EG
4011600EG	16	22	12-3/16	1	1-9/16	2-7/16	4600	EG
4011800EG	18	25-1/2	14-1/2	1-1/8	1-3/4	3-7/16	4800	EG
4012000EG	20	28-1/4	15-15/16	1-1/4	1-15/16	3-11/16	4800	EG
4012400EG	24	30-1/4	17-13/16	1-1/4	1-15/16	3-13/16	4800	EG
4013000EG	30	39-5/16	22	1-1/4	1-15/16	4-13/16	6000	EG

7

**Conforms With:** Federal Specification WW-H-171 (Type 1), Manufacturers Standardization Society ANSI/MSS-SP-58 (Type 1); install in accordance with ANSI/MSS-SP-69

All dimensions are in inches unless otherwise noted.

\*See page 2 for finish and material descriptions. All material is Carbon Steel unless otherwise noted.

# Clevis Hangers

## Model #402

### Clevis Hanger for Copper Tubing

**APPLICATION:** Recommended for the support of stationary, non-insulated copper tubing lines.

**NOTES:** This hanger is not designed for corrosion or electrolysis resistance. Copper coating is for identification purposes only.

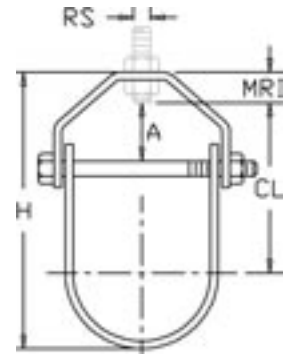

Part No.	Pipe Size	H	CL	RS	MRI	A	Max. Recom. Load (lbs)	Finish*
4020050CP	1/2	3	2-1/16	3/8	9/16	1	150	CP
4020075CP	3/4	2-7/8	1-13/16	3/8	9/16	1	250	CP
4020100CP	1	3-3/16	1-13/16	3/8	9/16	7/8	250	CP
4020125CP	1-1/4	3-15/16	2-5/8	3/8	9/16	1-5/16	250	CP
4020150CP	1-1/2	3-15/16	2-1/2	3/8	9/16	1-5/16	250	CP
4020200CP	2	4-13/16	3-1/8	3/8	9/16	1-7/16	250	CP
4020250CP	2-1/2	5-1/4	3-13/16	1/2	3/4	1-1/8	350	CP
4020300CP	3	5-11/16	3-1/4	1/2	3/4	1-3/16	350	CP
4020350CP	3-1/2	6-1/8	3-7/16	1/2	3/4	1-3/16	350	CP
4020400CP	4	6-5/8	3-11/16	1/2	3/4	1-1/8	400	CP
4020500CP	5	9-1/8	5-7/16	5/8	15/16	1-15/16	550	CP
4020600CP	6	10-3/16	5-7/8	3/4	1-1/16	1-15/16	550	CP
4020800CP	8	13-1/8	7-3/8	7/8	1-1/4	2-9/16	**	CP

**Conforms With:** Federal Specification **WW-H-171** (Type 12), Manufacturers Standardization Society **ANSI/MSS-SP-58** (Type 1); install in accordance with **ANSI/MSS-SP-69**

\*\* Contact ERICO



All dimensions are in inches unless otherwise noted.  
\*See page 2 for finish and material descriptions. All material is Carbon Steel unless otherwise noted.

# Clevis Hangers

## Model #403 Clevis Hanger with Insulation Shield

Flared edges  
on shield sizes  
thru 4 only

  
For 2-1/2  
thru 8 only

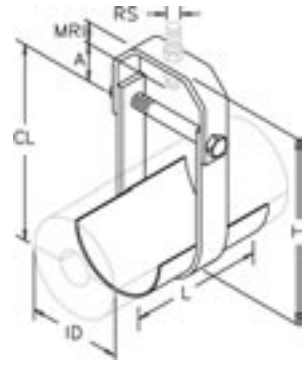

**APPLICATION:** For use with high density insulation or rigid support blocks at the point of support. Design is for insulation requiring a vapor barrier.

**NOTE:** Shield spot welded in place before plating, offering a neat appearance.

Part No.	Pipe Size	H	CL	RS	MRI	A	ID	L	Max. Recom. Load (lbs)	Finish*
4030150EG	1-1/2	5	3-3/16	3/8	9/16	1-7/16	1-7/8	3	610	EG
4030200EG	2	5-5/16	3-5/8	3/8	9/16	1-7/16	2-3/8	3	610	EG
4030250EG	2-1/2	5-9/16	3-1/8	3/8	3/4	1	3-1/8	4	1130	EG
4030300EG	3	6-3/16	3-7/16	1/2	3/4	1	3-5/8	4	1130	EG
4030350EG	3-1/2	6-11/16	3-11/16	1/2	3/4	1-7/16	4	4	1130	EG
4030400EG	4	8-1/16	4-5/8	5/8	15/16	1-7/16	4-1/2	6	1430	EG
4030450EG	4-1/2	9-1/8	5-1/16	5/8	15/16	1-13/16	5	6	1430	EG
4030500EG	5	9-3/8	5-5/16	5/8	15/16	1-3/4	5-9/16	6	1430	EG
4030600EG	6	10	5-5/16	3/4	1-1/16	1-13/16	6-5/8	6	1940	EG
4030700EG	7	11-11/16	6-9/16	3/4	1-1/16	2	7-5/8	6	1940	EG
4030800EG	8	13-1/8	7-3/16	7/8	1-3/16	2-5/16	8-5/8	6	2000	EG
4030900EG	9	14-3/8	7-15/16	7/8	1-3/16	2-1/8	9-5/8	6	2000	EG
4031000EG	10	16-5/16	9-3/16	7/8	1-5/16	2-1/2	10-3/4	6	3600	EG
4031100EG	11	18-3/8	10-7/16	7/8	1-5/16	2-1/2	11-3/4	8	3600	EG
4031200EG	12	19-5/8	11-11/16	7/8	1-5/16	2-3/8	12-3/4	8	3800	EG
4031400EG	14	20-1/2	11-11/16	1	1-9/16	2-7/16	14	8	4200	EG
4031500EG	15	20-5/8	10-13/16	1	1-9/16	2-7/16	15	8	4200	EG
4031600EG	16	22-1/2	12-11/16	1	1-9/16	3-7/16	16	8	4600	EG
4031700EG	17	24-5/16	13-5/16	1-1/8	1-3/4	3-7/16	17	10	4600	EG
4031800EG	18	26-1/4	15-1/4	1-1/8	1-3/4	3-7/16	18	10	4800	EG
4031900EG	19	26-3/16	13-7/8	1-1/4	1-15/16	3-11/16	19	10	4800	EG
4032100EG	21	29	16-5/16	1-1/4	1-15/16	3-11/16	20	10	4800	EG
4032200EG	22	29-1/4	15-15/16	1-1/4	1-15/16	3-11/16	21	10	4800	EG

7

**Conforms With:** Federal Specification **WW-H-171** (Type 1)\*\*; Manufacturers Standardization Society **ANSI/MSS-SP-58** (Type 1)\*\* ; install in accordance with **ANSI/MSS-SP-69**.

\*\* Principle component only.

All dimensions are in inches unless otherwise noted.

\*See page 2 for finish and material descriptions. All material is Carbon Steel unless otherwise noted.

# Clevis Hangers

## Model #405

### Clevis Hanger for AWWA Cast Iron Pipe

**APPLICATION:** Recommended for the support of stationary non-insulated cast iron pipe lines.

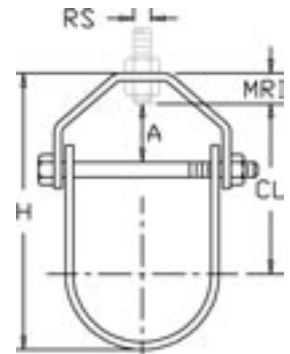

Part No.	Pipe Size	H	CL	RS	MRI	A	Max. Recom. Load (lbs)	Finish*
4050300EG	3	6-11/16	3-3/4	1/2	3/4	1	1130	EG
4050300PL	3	6-11/16	3-3/4	1/2	3/4	1	1130	PL
4050400EG	4	9-1/8	5-5/8	5/8	15/16	1-13/16	1430	EG
4050400PL	4	9-1/8	5-5/8	5/8	15/16	1-13/16	1430	PL
4050600EG	6	10-7/8	6-3/16	3/4	1-1/16	1-3/4	1940	EG
4050600PL	6	10-7/8	6-3/16	3/4	1-1/16	1-3/4	1940	PL
4050800EG	8	13-1/4	7-5/16	7/8	1-3/16	2	2000	EG
4050800PL	8	13-1/4	7-5/16	7/8	1-3/16	2	2000	PL
4051000EG	10	16-1/8	9-11/16	7/8	1-5/16	2-1/8	3600	EG
4051000PL	10	16-1/8	9-11/16	7/8	1-5/16	2-1/8	3600	PL
4051200EG	12	18-5/8	9-15/16	7/8	1-9/16	2-1/16	3800	EG
4051200PL	12	18-5/8	9-15/16	7/8	1-9/16	2-1/16	3800	PL
4051400EG	14	21-1/8	11-11/16	1	1-9/16	2-1/4	4200	EG
4051400PL	14	21-1/8	11-11/16	1	1-9/16	2-1/4	4200	PL
4051600EG	16	23-1/2	12-15/16	1	1-9/16	2-7/16	4600	EG
4051600PL	16	23-1/2	12-15/16	1	1-9/16	2-7/16	4600	PL
4051800EG	18	26-15/16	15-1/16	1-1/8	1-3/4	3-7/16	4800	EG
4051800PL	18	26-15/16	15-1/16	1-1/8	1-3/4	3-7/16	4800	PL
4052000EG	20	29-1/2	16-1/2	1-1/4	1-1/4	3-5/8	4800	EG
4052000PL	20	29-1/2	16-1/2	1-1/4	1-1/4	3-5/8	4800	PL
4052400EG	24	35-1/8	19-1/2	1-1/4	1-1/2	4-5/8	4800	EG
4052400PL	24	35-1/8	19-1/2	1-1/4	1-1/2	4-5/8	4800	PL
4053000PL	30	42	24	1-1/2	1-1/2	5-1/2	4800	PL

**Conforms With:** Federal Specification **WW-H-171** (Type 1), Manufacturers Standardization Society **ANSI/MSS-SP-58** (Type 1); install in accordance with **ANSI/MSS-SP-69**.



All dimensions are in inches unless otherwise noted.  
\*See page 2 for finish and material descriptions. All material is Carbon Steel unless otherwise noted.

# Clevis Hangers

## Model #406 Stainless Steel (304) Clevis Hanger

**APPLICATION:** Recommended for the support of stationary, non-insulated pipe lines.

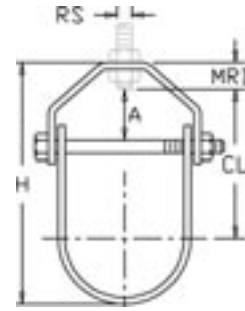

Part No.	Pipe Size	H	CL	RS	MRI	A	Max. Recom. Load (lbs)
4060050S4	1/2	2-1/2	1-7/16	3/8	9/16	3/8	610
4060075S4	3/4	2-3/4	1-9/16	3/8	9/16	3/8	610
4060100S4	1	3	1-11/16	3/8	9/16	3/8	610
4060125S4	1-1/4	3-3/8	1-13/16	3/8	9/16	3/8	610
4060150S4	1-1/2	3-7/8	2-3/16	3/8	9/16	11/16	610
4060200S4	2	4-7/8	2-15/16	3/8	9/16	1-1/8	610
4060250S4	2-1/2	6-1/8	3-3/4	1/2	3/4	1-3/16	1130
4060300S4	3	6-3/4	4-1/8	1/2	3/4	1-5/16	1130
4060350S4	3-1/2	6-11/16	3-11/16	1/2	3/4	1-7/16	1130
4060400S4	4	8-1/8	4-13/16	5/8	15/16	1-7/16	1430
4060500S4	5	9-5/8	5-11/16	5/8	15/16	1-3/4	1430
4060600S4	6	11-1/4	6-11/16	3/4	1-1/16	2-3/16	1940
4060800S4	8	14-3/4	8-15/16	7/8	1-3/16	3-1/4	2000
4061000S4	10	15-3/4	8-5/8	7/8	1-5/16	2-1/8	3600
4061200S4	12	18-7/8	10-15/16	7/8	1-5/16	2-1/2	3800
4061400S4	14	19-3/4	10-15/16	1	1-5/16	2-3/8	4200
4061600S4	16	22	12-3/16	1	1-9/16	2-7/16	4600
4061800S4	18	25-1/2	14-1/2	1-1/8	1-9/16	3-7/16	4800
4062000S4	20	28-1/4	15-15/16	1-1/4	1-3/4	3-11/16	4800
4062400S4	24	30-1/4	17-13/16	1-1/4	1-15/16	3-13/16	4800
4063000S4	30	39-5/16	22	1-1/4	1-15/16	4-13/16	6000

7

**Conforms With:** Federal Specification **WW-H-171** (Type 1), Manufacturers Standardization Society **ANSI/MSS-SP-58** (Type 1); install in accordance with **ANSI/MSS-SP-69**.

All dimensions are in inches unless otherwise noted.

\*See page 2 for finish and material descriptions. All material is Carbon Steel unless otherwise noted.

# Clevis Hangers

## Model #410 Light Duty Clevis Hanger

APPLICATION: Pipe or conduit hanger for light loads.

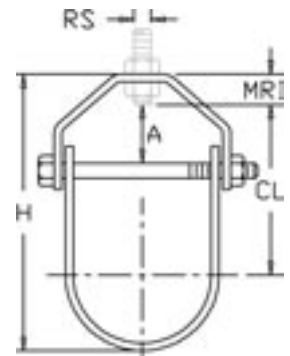

Part No.	Pipe Size	H	CL	RS	MRI	A	Max. Recom. Load (lbs)	Finish*
4100050EG	1/2	3	2-1/8	3/8	9/16	1	150	EG
4100050PL	1/2	3	2-1/8	3/8	9/16	1	150	PL
4100075EG	3/4	3	1-13/16	3/8	9/16	7/8	150	EG
4100075PL	3/4	3	1-13/16	3/8	9/16	7/8	150	PL
4100100EG	1	3-11/16	2-7/16	3/8	9/16	1-3/8	250	EG
4100100PL	1	3-11/16	2-7/16	3/8	9/16	1-3/8	250	PL
4100125EG	1-1/4	4	2-5/16	3/8	9/16	1-5/16	250	EG
4100125PL	1-1/4	4	2-5/16	3/8	9/16	1-5/16	250	PL
4100150EG	1-1/2	4-9/16	3	3/8	9/16	1-1/2	250	EG
4100150PL	1-1/2	4-9/16	3	3/8	9/16	1-1/2	250	PL
4100200EG	2	4-7/8	3-1/16	3/8	9/16	1-7/16	250	EG
4100200PL	2	4-7/8	3-1/16	3/8	9/16	1-7/16	250	PL
4100250EG	2-1/2	5-1/2	3-1/8	1/2	3/4	15/16	350	EG
4100250PL	2-1/2	5-1/2	3-1/8	1/2	3/4	15/16	350	PL
4100300EG	3	6-1/8	3-9/16	1/2	3/4	15/16	350	EG
4100300PL	3	6-1/8	3-9/16	1/2	3/4	15/16	350	PL
4100350EG	3-1/2	6-5/8	3-3/4	1/2	3/4	15/16	350	EG
4100350PL	3-1/2	6-5/8	3-3/4	1/2	3/4	15/16	350	PL
4100400EG	4	8	4-11/16	1/2	15/16	1-5/8	400	EG
4100400PL	4	8	4-11/16	1/2	15/16	1-5/8	400	PL

Conforms With: Federal Specification **WW-H-171** (Type 12), Manufacturers Standardization Society **ANSI/MSS-SP-58** (Type 1); install in accordance with **ANSI/MSS-SP-69**.

7



All dimensions are in inches unless otherwise noted.  
\*See page 2 for finish and material descriptions. All material is Carbon Steel unless otherwise noted.

# Clevis Hangers

## Model #415 Long Leg Insulation Clevis Hanger

**APPLICATION:** Pipe hanger for insulated services above ambient temperature which do not require guides, slides or rollers for movement.

**NOTE:** Bottom section of hanger is extended to make insulating over hanger less difficult.

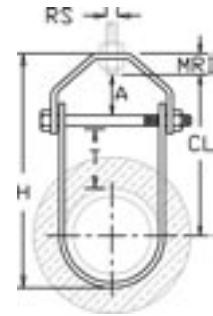

Part No.	Pipe Size	H	CL	RS	MRI	A	T (max)	Max. Recom. Load (lbs)	Finish*
4150050PL	1/2	4-1/4	3-7/16	3/8	9/16	9/16	2	610	PL
4150075PL	3/4	4-7/8	3-7/8	3/8	9/16	5/8	2	610	PL
4150100PL	1	5-3/4	4-11/16	3/8	9/16	1-5/8	2	610	PL
4150125PL	1-1/4	6-1/8	4-7/8	3/8	9/16	1-5/8	2	610	PL
4150150PL	1-1/2	6-3/8	5	3/8	9/16	1-1/2	2	610	PL
4150200PL	2	8-3/4	7-1/8	3/8	9/16	1-5/8	4	610	PL
4150250PL	2-1/2	9-1/4	7-3/16	1/2	3/4	1-1/8	4	1130	PL
4150300PL	3	9-7/8	7-1/2	1/2	3/4	1-1/8	4	1130	PL
4150400PL	4	11-7/8	8-7/8	5/8	15/16	1-3/4	4	1430	PL
4150500PL	5	13-1/8	6-13/16	5/8	15/16	1-7/8	4	1430	PL
4150600PL	6	14-1/8	9-15/16	3/4	1-1/16	1-5/8	4	1940	PL
4150800PL	8	16-7/8	11-9/16	7/8	1-3/16	2-1/8	4	2000	PL
4151000PL	10	18-5/8	12-1/8	7/8	1-5/16	1-3/4	4	3600	PL
4151200PL	12	22-1/8	14-5/8	7/8	1-5/16	2-5/8	4	3800	PL

7

**Conforms With:** Federal Specification **WW-H-171** (Type 1), Manufacturers Standardization Society **ANSI/MSS-SP-58** (Type 1); install in accordance with **ANSI/MSS-SP-69**.

All dimensions are in inches unless otherwise noted.

\*See page 2 for finish and material descriptions. All material is Carbon Steel unless otherwise noted.

# Clevis Hangers

## Model #420 PVC Coated Clevis Hanger

**APPLICATION:** Pipe hanger for use where it is undesirable to have the steel of the hanger in direct contact with the pipe; i.e. glass.



(For 2-1/2" thru 8" only)

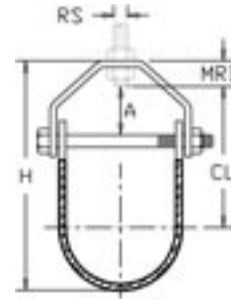

Part No.	Pipe Size	H	CL	RS	MRI	A	Max. Recom. Load (lbs)
4200050VC	1/2	2-1/2	1-7/16	3/8	9/16	3/8	610
4200075VC	3/4	2-3/4	1-9/16	3/8	9/16	3/8	610
4200100VC	1	3	1-11/16	3/8	9/16	3/8	610
4200125VC	1-1/4	3-3/8	1-13/16	3/8	9/16	3/8	610
4200150VC	1-1/2	3-7/8	2-3/16	3/8	9/16	11/16	610
4200200VC	2	4-7/8	2-15/16	3/8	9/16	1-1/8	610
4200250VC	2-1/2	6-1/8	3-3/4	1/2	3/4	1-3/16	1130
4200300VC	3	6-3/4	4-1/8	1/2	3/4	1-5/16	1130
4200350VC	3-1/2	6-11/16	3-11/16	1/2	3/4	1-7/16	1130
4200400VC	4	8-1/8	4-13/16	5/8	15/16	1-7/16	1430
4200500VC	5	9-5/16	5-11/16	5/8	15/16	1-3/4	1430
4200600VC	6	11-1/4	6-11/16	3/4	1-1/16	2-3/16	1430
4200800VC	8	14-3/4	8-15/16	7/8	1-5/16	3-1/4	2000
4201000VC	10	15-3/4	8-5/8	7/8	1-5/16	2-1/8	3600
4201200VC	12	18-7/8	10-15/16	7/8	1-5/16	2-1/2	3800
4201400VC	14	19-3/4	10-15/16	1	1-9/16	2-3/8	4200

**Conforms With:** Federal Specification **WW-H-171** (Type 1), Manufacturers Standardization Society **ANSI/MSS-SP-58** (Type 1); install in accordance with **ANSI/MSS-SP-69**.

7



All dimensions are in inches unless otherwise noted.  
\*See page 2 for finish and material descriptions. All material is Carbon Steel unless otherwise noted.