

Loop Hangers

Model #100 Swivel Loop Hanger - Heavy Duty

APPLICATION: #100 pipe support for stationary piping.
Lowest in-place cost available. Easy adjustment.

NOTE: Meets MSS requirements.

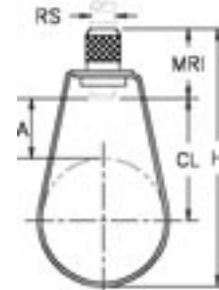

Part No.	Pipe Size	H	CL	RS	MRI	A	Max. Recom. Load (lbs.)	Finish*
1000050EG	1/2	2-3/4	1-1/4	3/8	1	13/16	300	EG
1000050FL	1/2	2-3/4	1-1/4	3/8	1	13/16	300	FL
1000075EG	3/4	3-1/16	1-7/16	3/8	1	15/16	300	EG
1000075FL	3/4	3-1/16	1-7/16	3/8	1	15/16	300	FL
1000100EG	1	3-5/16	1-9/16	3/8	1	15/16	300	EG
1000100FL	1	3-5/16	1-9/16	3/8	1	15/16	300	FL
1000125EG	1-1/4	3-9/16	1-5/8	3/8	1	13/16	300	EG
1000125FL	1-1/4	3-9/16	1-5/8	3/8	1	13/16	300	FL
1000150EG	1-1/2	3-13/16	1-3/4	3/8	1	13/16	300	EG
1000150FL	1-1/2	3-13/16	1-3/4	3/8	1	13/16	300	FL
1000200EG	2	4-1/4	1-15/16	3/8	1	13/16	300	EG
1000200FL	2	4-1/4	1-15/16	3/8	1	13/16	300	FL
1000250EG	2-1/2	5-5/8	2-15/16	1/2	1-1/4	1-5/16	1000	EG
1000250FL	2-1/2	5-5/8	2-15/16	1/2	1-1/4	1-5/16	1000	FL
1000300EG	3	6-9/16	3-1/2	1/2	1-1/4	1-7/16	1000	EG
1000300FL	3	6-9/16	3-1/2	1/2	1-1/4	1-7/16	1000	FL
1000350EG	3-1/2	7	3-3/4	1/2	1-1/4	1-11/16	1000	EG
1000350FL	3-1/2	7	3-3/4	1/2	1-1/4	1-11/16	1000	FL
1000400EG	4	7-3/4	4-5/16	5/8	1-5/16	1-3/4	1100	EG
1000400FL	4	7-3/4	4-5/16	5/8	1-5/16	1-3/4	1100	FL
1000500EG	5	9-1/8	4-5/16	5/8	1-5/16	1-13/16	1100	EG
1000600EG	6	10-5/8	5-7/8	3/4	1-9/16	2-1/8	1250	EG
1000800EG	8	13-1/8	7-1/16	7/8	1-5/8	2-3/8	1250	EG

6

Conforms With: Federal Specification **WW-H-171** (Type 10), Manufacturers Standardization Society **ANSI/MSS-SP-58** (Type 10), install in accordance with **ANSI/MSS-SP-69**.

All dimensions are in inches unless otherwise noted.

*See page 2 for finish and material descriptions. All material is Carbon Steel unless otherwise noted.

Loop Hangers

Model #101 Swivel Loop Hanger for Copper Tubing

APPLICATION: Support for copper tubing. This pipe support is not designed for corrosion or electrolysis resistance. Copper coating is for identification purposes only.

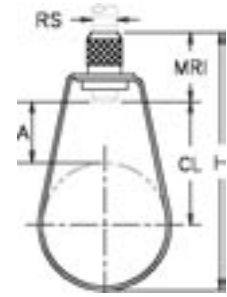

Part No.	Tubing Size	H	CL	RS	MRI	A	Max. Recom. Load (lbs.)	Finish*
1010050CP	1/2	3-3/16	1-13/16	3/8	1	1-1/2	300	CP
1010075CP	3/4	3-1/8	1-11/16	3/8	1	1-1/4	300	CP
1010100CP	1	3-1/8	1-1/2	3/8	1	15/16	300	CP
1010125CP	1-1/4	3-3/16	1-7/16	3/8	1	3/4	300	CP
1010150CP	1-1/2	3-5/8	1-3/4	3/8	1	15/16	300	CP
1010200CP	2	3-13/16	1-11/16	3/8	1	5/8	300	CP
1010250CP	2-1/2	4-7/16	2-1/16	1/2	1	3/4	525	CP
1010300CP	3	5-11/16	2-13/16	1/2	1-1/4	1-1/4	525	CP
1010350CP	3-1/2	6-7/16	3-5/16	1/2	1-1/4	1-1/2	650	CP
1010400CP	4	7-1/8	3-3/4	1/2	1-1/4	1-5/8	650	CP
1010500CP	5	9-1/4	4-13/16	5/8	1-5/16	2-1/4	1100	CP
1010600CP	6	11-3/16	5-11/16	3/4	1-9/16	2-5/8	1250	CP

Conforms With: Federal Specification **WW-H-171** (Type 10), Manufacturers Standardization Society **ANSI/MSS-SP-58** (Type 10); install in accordance with **ANSI/MSS-SP-69**.

Model #102 PVC Coated Swivel Loop Hanger

APPLICATION: Pipe support for stationary glass, aluminum and plastic piping, where pipe to metal hanger contact is undesirable.



Part No.	Tubing Size	H	CL	RS	MRI	A	Max. Recom. Load (lbs.)	Finish*
1020050VC	1/2	3-1/8	1-5/8	3/8	1	1-1/4	300	PVC
1020075VC	3/4	3-1/16	1-1/2	3/8	1	15/16	300	PVC
1020100VC	1	3-3/16	1-1/2	3/8	1	15/16	300	PVC
1020125VC	1-1/4	3-1/2	1-11/16	3/8	1	7/8	300	PVC
1020150VC	1-1/2	3-15/16	1-15/16	3/8	1	1	300	PVC
1020200VC	2	4-1/2	2-1/4	3/8	1	1-1/16	300	PVC
1020250VC	2-1/2	5-5/8	2-15/16	1/2	1-1/4	1-5/16	1000	PVC
1020300VC	3	6-9/16	3-1/2	1/2	1-1/4	1-7/16	1000	PVC
1020350VC	3-1/2	7	3-3/4	1/2	1-1/4	1-11/16	1000	PVC
1020400VC	4	7-3/4	4-5/16	5/8	1-5/16	1-3/4	1100	PVC
1020500VC	5	9-1/8	4-15/16	5/8	1-5/16	1-13/18	1100	PVC
1020600VC	6	10-5/8	5-7/8	3/4	1-9/16	2-1/8	1250	PVC
1020800VC	8	13-1/8	7-1/16	7/8	1-5/8	2-3/8	1250	PVC

Conforms With: Federal Specification **WW-H-171** (Type 10), Manufacturers Standardization Society **ANSI/MSS-SP-58** (Type 10); install in accordance with **ANSI/MSS-SP-69**.



*See page 2 for finish and material descriptions. All dimensions are in inches unless otherwise noted. All material is Carbon Steel unless otherwise noted.

Loop Hangers

Model #102A PVC Coated Swivel Loop Hanger for Copper Tubing

APPLICATION: Support for copper tubing where tube to metal hanger contact is undesirable. Stops electrolysis and light corrosion.

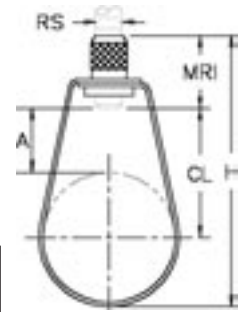

Part No.	Tubing Size	H	CL	RS	MRI	A	Max. Recom. Load (lbs.)	Finish*
102A0050VC	1/2	3-3/16	1-13/16	3/8	1	1-1/2	300	PVC
102A0075VC	3/4	3-1/8	1-11/16	3/8	1	1-1/4	300	PVC
102A0100VC	1	3-1/8	1-1/2	3/8	1	15/16	300	PVC
102A0125VC	1-1/4	3-3/16	1-7/16	3/8	1	3/4	300	PVC
102A0150VC	1-1/2	3-5/8	1-3/4	3/8	1	15/16	300	PVC
102A0200VC	2	3-13/16	1-11/16	3/8	1	5/8	300	PVC
102A0250VC	2-1/2	4-7/16	2-1/16	3/8	1	3/4	525	PVC
102A0300VC	3	5-11/16	2-13/16	1/2	1-1/4	1-1/4	525	PVC
102A0350VC	3-1/2	6-7/16	3-5/16	1/2	1-1/4	1-1/2	650	PVC
102A0400VC	4	7-1/8	3-3/4	1/2	1-1/4	1-5/8	650	PVC
102A0500VC	5	9-1/4	4-13/16	5/8	1-5/16	2-1/4	1100	PVC
102A0600VC	6	11-3/16	5-11/16	3/4	1-9/16	2-5/8	1250	PVC

6

Conforms With: Federal Specification **WW-H-171** (Type 10), Manufacturers Standardization Society **ANSI/ MSS-SP-58** (Type 10); install in accordance with **ANSI/MSS-SP-69**.

Model #103 Swivel Loop Hanger with Insulation Shield

APPLICATION: Pipe support for low or high temperature piping where crush resistant material is require at the point of support. Not to be used with pipe insulation which has more than 5% deformation at 30 p.s.i.

NOTE: For hanger size larger than 8", see Model #403. Insure that the insulation O.D. is equal to or less than the inside Diameter (ID) dimension. Protection shield is welded to loop before plating, offering an extremely neat appearance. See Model #1031 for pre-insulated hanger.

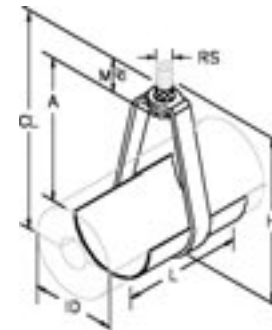

Flared edges on sizes thru 4" only. Insulation not included.

Part No.	Tubing Size	H	CL	RS	ID	MRI	A	L	Max. Recom. Load (lbs.)	Finish*
1030150EG	1-1/2	3-15/16	1-7/8	3/8	1-15/16	1	15/16	3	300	EG
1030200EG	2	4-1/2	2-3/16	3/8	1	1	1	3	300	EG
1030250EG	2-1/2	5-5/8	2-7/8	1/2	1-1/4	1-1/14	1-1/4	4	1000	EG
1030300EG	3	6-9/16	3-7/16	1/2	1-3/8	1-1/14	1-3/8	4	1000	EG
1030350EG	3-1/2	7	3-11/16	1/2	1-5/8	1-1/14	1-5/8	4	1000	EG
1030400EG	4	7-3/4	4-1/4	5/8	1-11/16	1-5/16	1-11/16	6	1000	EG
1030500EG	5	9-1/8	4-7/8	5/8	1-3/4	1-5/16	1-3/4	6	1000	EG
1030600EG	6	10-5/8	5-13/16	3/4	2-1/16	1-9/16	2-1/16	6	1250	EG
1030800EG	8	13-1/8	7-1/16	7/8	2-5/16	1-5/8	2-5/16	6	1250	EG

All dimensions are in inches unless otherwise noted.

*See page 2 for finish and material descriptions. All material is Carbon Steel unless otherwise noted.

Loop Hangers

Model #104 Hanger for Plastic Pipe

APPLICATION: Designed for hanging flexible EPDM or Polypropylene plastic piping. Use hanger for rigid plastic pipe or with V-Trough (See Model VTR) for continuous support of flexible pipe or hot piping services.

NOTE: Hangers and V-Trough (See Model VTR) are sold separately.

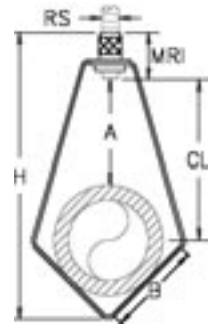

6

Part No.	Size No.	Pipe Size	H	CL	RS	MRI	A	Max. Recom. Load (lbs.)	Finish*
1040100EG	1 B = 2-1/2"	1/2	5-7/8	4-3/8	3/8	7/8	3-15/16	175	EG
		3/4	5-7/8	4-1/4	3/8	7/8	3-3/4	175	EG
		1	5-7/8	4-1/16	3/8	7/8	3-3/8	175	EG
		1-1/4	5-7/8	3-13/16	3/8	7/8	3	175	EG
		1-1/2	5-7/8	3-5/8	3/8	7/8	2-3/4	175	EG
1040200EG	2 B = 4"	2	5-7/8	3-5/16	3/8	7/8	2-1/8	175	EG
		2-1/2	9-1/4	6-1/16	1/2	1-1/8	4-5/8	175	EG
		3	9-1/4	5-5/8	1/2	1-1/8	3-7/8	175	EG
		3-1/2	9-1/4	5-5/16	1/2	1-1/8	3-5/16	175	EG
		4	9-1/4	4-15/16	1/2	1-1/8	2-11/16	175	EG

Model VTR V-Trough

APPLICATION: Use with #104 Hanger for continuous support of flexible or hot pipe services.

NOTE: Trough is 18 gauge Carbon Steel and Pre-Galvanized.

Part No.	Pipe Size	Size	Finish*
VTR#11000	1/2 thru 2	#1	Pre-Gal
VTR#21000	2-1/2 thru 4	#2	Pre-Gal

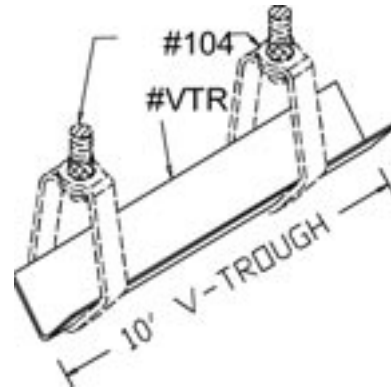

*See page 2 for finish and material descriptions. All material is Carbon Steel unless otherwise noted.

Loop Hangers

Model #105 304 Stainless Steel Swivel Loop Hanger

APPLICATION: Pipe support for stationary stainless steel piping.

NOTE: Swivel nut not furnished with hanger. Stainless steel hex nuts recommended for use with hanger.

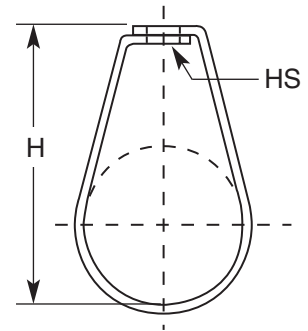

Part No.	Pipe Size	Gauge	H	W	HS	Finish*
1050050S4	1/2	15	2-27/32	3/4	7/16	304SS
1050075S4	3/4	15	3-3/64	3/4	7/16	304SS
1050100S4	1	15	3-5/16	3/4	7/16	304SS
1050125S4	1-1/4	15	3-21/32	3/4	7/16	304SS
1050150S4	1-1/2	15	4	3/4	7/16	304SS
1050200S4	2	15	4-3/8	3/4	7/16	304SS
1050250S4	2-1/2	15	4-7/8	1	9/16	304SS
1050300S4	3	15	5-1/2	1	9/16	304SS
1050350S4	3-1/2	15	6	1	9/16	304SS
1050400S4	4	15	6-1/2	1-1/4	11/16	304SS
1050500S4	5	15	7-9/16	1-1/4	11/16	304SS
1050600S4	6	11	8-5/8	1-1/4	13/16	304SS
1050800S4	8	11	10-5/8	1-3/8	15/16	304SS

6

Conforms With: Federal Specification **WW-H-171** (Type 10), Manufacturers Standardization Society **ANSI/MSS-SP -58** (Type 10), install in accordance with **ANSI/MSS-SP-69**.

Model #115 Swivel Loop Hanger – NFPA

APPLICATION: Pipe support manufactured to use minimum rod sizes permitted by NFPA for fire sprinkler piping.

NOTE: For 1/2" to 2", See Model #100 Page 48.

NOTE: Meets NFPA requirements.

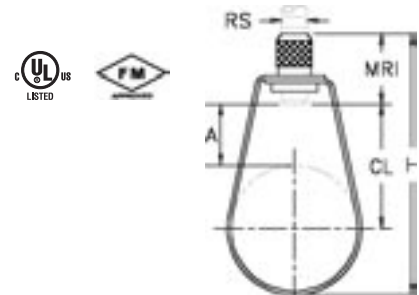

Part No.	Pipe Size	H	CL	RS (NFPA)	MRI	A	Max. Recom. Load (lbs)	Finish*
1150250EG	2-1/2	4-13/16	2-3/8	3/8	1	15/16	525	EG
1150300EG	3	5-5/8	2-7/8	3/8	1	1-1/8	525	EG
1150350EG	3-1/2	6-3/16	3-1/8	3/8	1	1-1/8	585	EG
1150400EG	4	6-13/16	3-1/2	3/8	1	1-1/4	650	EG
1150500EG	5	8-5/8	4-1/2	1/2	1-1/4	1-1/4	1000	EG
1150600EG	6	9-7/8	5-1/4	1/2	1-1/4	1-15/16	1000	EG
1150800EG	8	12-1/2	6-13/16	1/2	1-1/4	2-1/2	1000	EG

Conforms With: Federal Specification **WW-H-171** (Type 10), Manufacturers Standardization Society **ANSI/MSS-SP -58** (Type 10), install in accordance with **ANSI/MSS-SP-69**.

All dimensions are in inches unless otherwise noted.

*See page 2 for finish and material descriptions. All material is Carbon Steel unless otherwise noted.