

Intermediate Attachments

Model #25/25S Steel Rod Coupling

APPLICATION: An intermediate accessory designed to join two lengths of similar UNC threaded rod.

NOTE: Installer must thread rod ends into coupling equally until they meet in the middle of the coupling.

NOTE: Available in HD finish

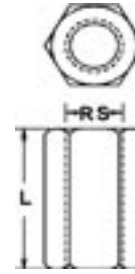

5

Part No.	RS	L	Max. Recom. Load (lbs)	Finish*
0250025EG	1/4	7/8	240	EG
0250037EG	3/8	1-3/4	610	EG
0250050EG	1/2	1-3/4	1130	EG
0250062EG	5/8	2-1/8	1810	EG
0250075EG	3/4	2-1/4	2710	EG
0250087EG	7/8	2-1/2	3770	EG
025S0037EG†	3/8	1-1/8	N/A	EG
025S0050EG†	1/2	1-1/4	N/A	EG

† Short coupling

Model #25R Reducing Rod Coupling

APPLICATION: An intermediate accessory designed to join dissimilar sizes of UNC rod.

NOTE: Never use smaller rod sizes than the minimum rod sizes noted in ANSI/MSS-SP-69. For specific pipe sizes see page 111.

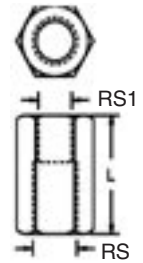

Part No.	RS	RS1	L	Max. Pipe Size	Max. Recom. Size	Finish* Load (lbs.)
025R3725EG	3/8	1/4	1	3/8	240	EG
025R5037EG	1/2	3/8	1-1/4	2	610	EG
025R6250EG	5/8	1/2	1-1/4	3-1/2	1130	EG

Model #26 Malleable Extension Piece

APPLICATION: An intermediate accessory which may attach to the side of a structural member or to a beam clamp. May be used in conjunction with Models: #360.

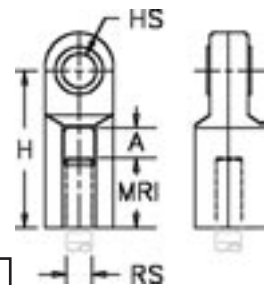

Part No.	RS	H	MRI	A	HS	Max. Recom. Load (lbs.)	Finish*
0260037PL	3/8	2-1/16	5/8	3/4	1/2	610	PL
0260050PL	1/2	2-3/8	11/16	3/4	1/2	1130	PL
0260062PL	5/8	2-1/2	7/8	11/16	1/2	1550	PL
0260075PL	3/4	2-7/8	1	13/16	1/2	2100	PL
0260087PL	7/8	3-1/16	1-1/16	13/16	9/16	2350	PL



All dimensions are in inches unless otherwise noted.
*See page 2 for finish and material descriptions. All material is Carbon Steel unless otherwise noted.

Intermediate Attachments

Model #30 Forged Steel Turnbuckle

APPLICATION: An intermediate accessory which provides up to 6" vertical adjustment for heavy loads.

NOTE: Ends are threaded in opposite directions.

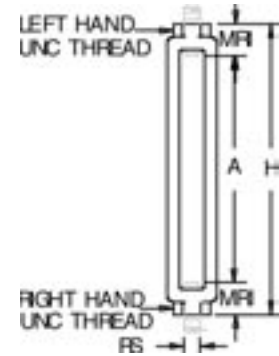

Part No.	RS	H	MRI	A	Max. Recom. Load (lbs.)	Finish*
0300037PL	3/8	7-1/8	1-11/16	5-3/4	1200	PL
0300050PL	1/2	7-1/2	7/8	5-5/8	2200	PL
0300062PL	5/8	7-7/8	1-1/8	5-5/8	3500	PL
0300075PL	3/4	8-1/4	1-7/16	5-5/8	5200	PL
0300087PL	7/8	8-5/8	1-9/16	5-1/2	7200	PL

5

Conforms With: Federal Specification **WW-H-171** (Type 13), Manufacturers Standardization Society **MSS-SP-58** (Type 13), install in accordance with **ANSI/MSS-SP-69**.

Model #31 Forged Steel Clevis

APPLICATION: An intermediate accessory designed to attach to vertical plates which have been welded to structure or pipe.

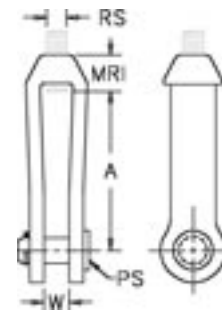

Part No.	RS	Body No.	MRI	A	PS	W	Max. Recom. Load (lbs.)	Finish*
0310037PL	3/8	2	15/16	3-5/8	1/2	3/8	610	PL
0310050PL	1/2	2	15/16	3-5/8	5/8	1/2	1130	PL
0310062PL	5/8	2	1-1/16	3-5/8	3/4	5/8	1810	PL
0310075PL	3/4	2-1/2	1-3/16	4	7/8	3/4	2710	PL
0310087PL	7/8	2-1/2	1-3/16	4	1	7/8	3770	PL
0310100PL	1	3	1-7/16	4-15/16	1-1/8	1	4960	PL
0310125PL	1-1/4	3	1-1/2	4-15/16	1-1/2	1-1/4	8000	PL
0310150PL	1-1/2	3-1/2	2-1/16	6	1-3/4	1-1/2	11630	PL
0310175PL	1-3/4	4	2-9/16	6	2	1-3/4	15700	PL
0310200PL	2	5	2-11/16	7	2-1/4	2	20700	PL

Conforms With: Federal Specification **WW-H-171** (Type 14), Manufacturers Standardization Society **ANSI/MSS-SP-58** (Type 14), install in accordance with **ANSI/MSS-SP-69**.

All dimensions are in inches unless otherwise noted.

*See page 2 for finish and material descriptions. All material is Carbon Steel unless otherwise noted.

Intermediate Attachments

Model #35 Forged Steel Eye Nut

APPLICATION: An intermediate accessory for high temperature piping used in conjunction with Models: #320, #360, #361, #450, #451, #452, #453.

NOTE: Larger sizes available by special order. Available with EG finish.

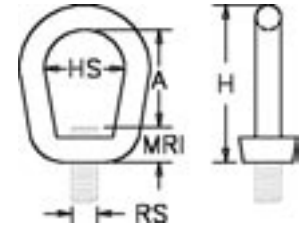

Part No.	RS	H	MRI	A	HS	Max. Recom. Load (lbs.)	Finish*
0350037PL	3/8	2-1/16	5/8	1-1/16	1	1250	PL
0350050PL	1/2	3-1/8	3/4	1-11/16	1-1/2	2250	PL
0350062PL	5/8	3-1/8	3/4	1-11/16	1-1/2	3600	PL
0350075PL	3/4	3-1/8	3/4	1-11/16	1-1/2	5200	PL
0350087PL	7/8	4-3/8	1-1/8	2-3/8	2	7200	PL

Conforms With: Federal Specification WW-H-171 (Type17), Manufacturers Standardization Society ANSI/MSS-SP-58 (Type 17), install in accordance with ANSI/MSS-SP-69.

Model #40 Eye Rod

APPLICATION: Structural attachment with Model #42 lag screw or as a hanger rod from other structural attachments. Can be used in connection with Models: #360, #361, etc.

Part No.	RS	L (Min)	L1	HS	Max. Recom. Load (lbs.)	Finish*
0403704PL	3/8	4	2-1/2	1/2	240	PL
0403706PL	3/8	6	2-1/2	1/2	240	PL
0403708PL	3/8	8	2-1/2	1/2	240	PL

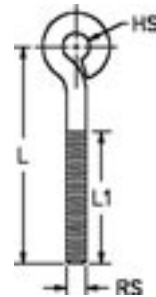

Model #47 Malleable Eye Socket

APPLICATION: Intermediate attachment for various types of pipe supports and structural attachments.

NOTE: Available with EG finish.

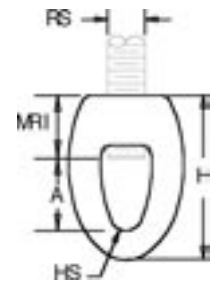

Part No.	RS	H	MRI	A	HS	Max. Recom. Load (lbs.)	Material	Finish*
0470025PL	1/4	1-3/4	1/2	5/8	5/16	230	Malleable Iron	PL
0470037PL	3/8	1-5/8	5/8	3/4	3/8	610	Malleable Iron	PL
0470050PL	1/2	1-7/8	3/4	3/4	3/8	1130	Malleable Iron	PL
0470062PL	5/8	2-1/8	3/4	15/16	5/8	1400	Malleable Iron	PL
0470075PL	3/4	2-1/2	7/8	1-3/16	5/8	1900	Malleable Iron	PL
0470087PL	7/8	2-7/8	1-1/16	1-1/4	5/8	2200	Malleable Iron	PL

Conforms With: Federal Specification WW-H-171 (Type 16), Manufacturers Standardization Society ANSI/ MSS-SP-58 (Type 16), install in accordance with ANSI/MSS-SP-69.



All dimensions are in inches unless otherwise noted.
*See page 2 for finish and material descriptions. All material is Carbon Steel unless otherwise noted.

Intermediate Attachments

Model #50 All Thread Rod

APPLICATION: To attach hangers to structural attachments without threading the rod. (UNC Thread Form)

NOTE: Low carbon: tensile: 58,000 psi; yield: 36,000 psi.
Available in SS for 3/8 and 1/2 rod size.

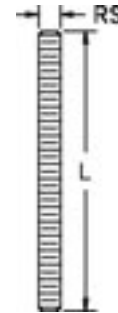

5

Part No.	Rod Size RS	L	Max. Recom. Load (lbs.)†	Finish*
0502506EG	1/4	6'	240	EG
0502506PL	1/4	6'	240	PL
0502510EG	1/4	10'	240	EG
0502510PL	1/4	10'	240	PL
0502512EG	1/4	12'	240	EG
0502512PL	1/4	12'	240	PL
0503706EG	3/8	6'	610	EG
0503706PL	3/8	6'	610	PL
0503710EG	3/8	10'	610	EG
0503710PL	3/8	10'	610	PL
0503712EG	3/8	12'	610	EG
0503712PL	3/8	12'	610	PL
0505006EG	1/2	6'	1130	EG
0505006PL	1/2	6'	1130	PL
0505010EG	1/2	10'	1130	EG
0505010PL	1/2	10'	1130	PL
0505012EG	1/2	12'	1130	EG
0505012PL	1/2	12'	1130	PL
0506206EG	5/8	6'	1810	EG
0506206PL	5/8	6'	1810	PL
0506210EG	5/8	10'	1810	EG
0506210PL	5/8	10'	1810	PL
0506212EG	5/8	12'	1810	EG
0506212PL	5/8	12'	1810	PL
0507506EG	3/4	6'	2710	EG
0507506PL	3/4	6'	2710	PL
0507510EG	3/4	10'	2710	EG
0507510PL	3/4	10'	2710	PL
0507512EG	3/4	12'	2710	EG
0507512PL	3/4	12'	2710	PL
0508706EG	7/8	6'	3770	EG
0508706PL	7/8	6'	3770	PL
0508710EG	7/8	10'	3770	EG
0508710PL	7/8	10'	3770	PL
0508712EG	7/8	12'	3770	EG
0508712PL	7/8	12'	3770	PL

†Load Based on Max. 650°F.

All dimensions are in inches unless otherwise noted.

*See page 2 for finish and material descriptions. All material is Carbon Steel unless otherwise noted.

Intermediate Attachments

Model #51 Threaded Stud

APPLICATION: To attach hangers to structural attachments without threading or cutting the rod. (UNC Thread Form).

NOTE: Low carbon; tensile: 58,000 psi; yield: 36,000 psi.

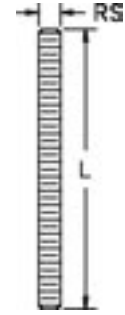

5

Part No.	RS	L Inches	Max. Recom. Load (lbs.)†	Finish*
0513702PL	3/8	2	610	PL
0513703PL	3/8	3	610	PL
0513704PL	3/8	4	610	PL
0513705PL	3/8	5	610	PL
0513706PL	3/8	6	610	PL
0513707PL	3/8	7	610	PL
0513708PL	3/8	8	610	PL
0513710PL	3/8	10	610	PL
0513711PL	3/8	11	610	PL
0513712PL	3/8	12	610	PL
0515002PL	1/2	2	1130	PL
0515003PL	1/2	3	1130	PL
0515004PL	1/2	4	1130	PL
0515005PL	1/2	5	1130	PL
0515006PL	1/2	6	1130	PL
0515007PL	1/2	7	1130	PL
0515008PL	1/2	8	1130	PL
0515010PL	1/2	10	1130	PL
0515011PL	1/2	11	1130	PL
0515012PL	1/2	12	1130	PL

†Load based on Max. 650°F



All dimensions are in inches unless otherwise noted.
*See page 2 for finish and material descriptions. All material is Carbon Steel unless otherwise noted.

Intermediate Attachments

Model #85 Threaded J-Bolt

APPLICATION: Designed to allow bolt to be hooked or hung from beam flange or purlin.

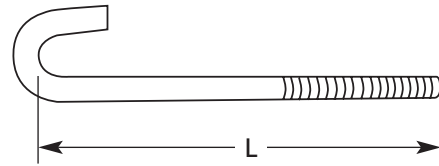

Part No.	RS	L Inches	Max. Recom. Load (lbs.)	Finish*
085370400PL	3/8	4	240	PL
085370500PL	3/8	5	240	PL
085370600PL	3/8	6	240	PL
085370700PL	3/8	7	240	PL
085370800PL	3/8	8	240	PL
085370900PL	3/8	9	240	PL
085371000PL	3/8	10	240	PL
085500600PL	1/2	6	440	PL
085500700PL	1/2	7	440	PL
085500800PL	1/2	8	440	PL
085500900PL	1/2	9	440	PL
085501000PL	1/2	10	440	PL

5

Model #80 Tie Bolt

APPLICATION: Primarily used to secure connection of installation of private fire service mains.

NOTE: Conforms to NFPA pamphlet #2, 4"-12" pipe size

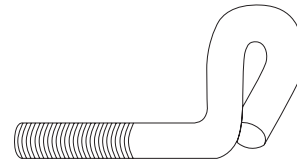

Part No.	Size	Finish*
080750459PL	3/4 x 4-1/2	PL

Model #15 Rod Button

APPLICATION: Recommended for giving a finished appearance where rod enters ceiling.

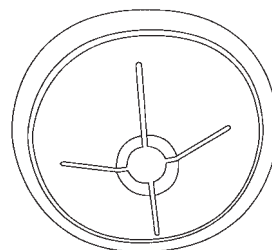

Part No.	Size	Color
0150037W	3/8	White
0150037PC	3/8	Chrome
0150050W	1/2	White

All dimensions are in inches unless otherwise noted.

*See page 2 for finish and material descriptions. All material is Carbon Steel unless otherwise noted.

Intermediate Attachments

Model #150 Standard U-Bolt

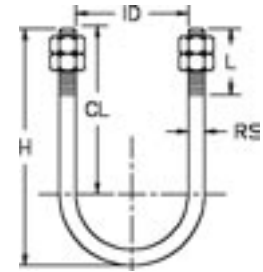

APPLICATION: Pipe support for general piping applications.

NOTE: Four hex nuts included.

Available in SS by special order.

Available with HD finish by special order.

5

Part No.	Pipe Size	H	CL	RS**	L	ID	Max. Recom. Load (lbs)	Finish*
1500050EG	1/2	3-7/16	2-3/4	1/4	2-3/8	15/16	435	EG
1500050PL	1/2	3-7/16	2-3/4	1/4	2-3/8	15/16	435	PL
1500075EG	3/4	3-9/16	2-3/4	1/4	2-3/8	1-1/8	435	EG
1500075PL	3/4	3-9/16	2-3/4	1/4	2-3/8	1-1/8	435	PL
1500100EG	1	3-11/16	2-3/4	1/4	2-3/8	1-3/8	435	EG
1500100PL	1	3-11/16	2-3/4	1/4	2-3/8	1-3/8	435	PL
1500125EG	1-1/4	4-1/8	2-7/8	3/8	2-3/8	1-11/16	1090	EG
1500125PL	1-1/4	4-1/8	2-7/8	3/8	2-3/8	1-11/16	1090	PL
1500150EG	1-1/2	4-3/8	3	3/8	2-1/2	2	1090	EG
1500150PL	1-1/2	4-3/8	3	3/8	2-1/2	2	1090	PL
1500200EG	2	4-7/8	3-1/4	3/8	2-5/8	2-7/16	1090	EG
1500200PL	2	4-7/8	3-1/4	3/8	2-5/8	2-7/16	1090	PL
1500250EG	2-1/2	5-3/4	3-3/4	1/2	3	2-15/16	2020	EG
1500250PL	2-1/2	5-3/4	3-3/4	1/2	3	2-15/16	2020	PL
1500300EG	3	6-1/4	4	1/2	3	3-9/16	2020	EG
1500300PL	3	6-1/4	4	1/2	3	3-9/16	2020	PL
1500350EG	3-1/2	6-13/16	4-1/4	1/2	3	4-1/16	2020	EG
1500350PL	3-1/2	6-13/16	4-1/4	1/2	3	4-1/16	2020	PL
1500400EG	4	7-1/4	4-1/2	1/2	3	4-9/16	2020	EG
1500400PL	4	7-1/4	4-1/2	1/2	3	4-9/16	2020	PL
1500500EG	5	8-5/16	5	1/2	3	5-5/8	2020	EG
1500500PL	5	8-5/16	5	1/2	3	5-5/8	2020	PL
1500600EG	6	10-1/16	6-1/8	5/8	3-3/4	6-3/4	3230	EG
1500600PL	6	10-1/16	6-1/8	5/8	3-3/4	6-3/4	3230	PL
1500800EG	8	12-1/8	7-1/8	5/8	3-3/4	8-3/4	3230	EG
1500800PL	8	12-1/8	7-1/8	5/8	3-3/4	8-3/4	3230	PL
1501000EG	10	14-9/16	8-3/8	3/4	4	10-7/8	4830	EG
1501000PL	10	14-9/16	8-3/8	3/4	4	10-7/8	4830	PL
1501200EG	12	16-15/16	9-5/8	7/8	4-1/4	12-7/8	6730	EG
1501200PL	12	16-15/16	9-5/8	7/8	4-1/4	12-7/8	6730	PL
1501400EG	14	18-13/16	10-1/4	7/8	4-1/4	14-1/8	6730	EG
1501400PL	14	18-13/16	10-1/4	7/8	4-1/4	14-1/8	6730	PL
1501600EG	16	22-3/16	11-1/4	7/8	4-3/4	16-1/8	6730	EG
1501600PL	16	22-3/16	11-1/4	7/8	4-3/4	16-1/8	6730	PL
1501800EG	18	22-11/16	12-5/8	1	4-3/4	18-1/8	8850	EG
1501800PL	18	22-11/16	12-5/8	1	4-3/4	18-1/8	8850	PL
1502000EG	20	24-11/16	13-5/8	1	4-3/4	20-1/8	8850	EG
1502000PL	20	24-11/16	13-5/8	1	4-3/4	20-1/8	8850	PL
1502400EG	24	28-11/16	15-5/8	1	4-3/4	24-1/8	8850	EG
1502400PL	24	28-11/16	15-5/8	1	4-3/4	24-1/8	8850	PL
1503000EG	30	34-11/16	18-5/8	1	4-3/4	30-1/8	8850	EG
1503000PL	30	34-11/16	18-5/8	1	4-3/4	30-1/8	8850	PL

** Pitch diameter on rolled threads.

Conforms With: Federal Specification WW-H-171 (Type 24), Manufacturers Standardization Society ANSI/MSS-SP-58 (Type 24); install in accordance with ANSI/MSS-SP-69



All dimensions are in inches unless otherwise noted.
*See page 2 for finish and material descriptions. All material is Carbon Steel unless otherwise noted.