



Model FLX1 Flexible Coupling

cULus Listed, FM Approved
300 psi (20.7 bar)

FLX1 Flexible Coupling Technical Data

<p>Operating Specifications Maximum Working Pressure: 300 psi (20.7 bar) Operating Temperature -30 °F to 230 °F (-34 °C to 110 °C)</p> <p>Material Specifications Housings: ASTM A536 Grade 65-45-12 Ductile Iron Gasket: Pre-lubricated Grade E EPDM</p> <p>Design Specification Groove: AWWA-C606</p>	<p>Bolt Specification: ISO 898-1 Grade 8.8</p> <p>Available Finishes Housing: Red powder coating Hot dipped galvanized (ASTM A-153) Bolts: Zinc Electroplating</p> <p>Listings and Approvals cULus Listed FM Approved</p>	
--	--	--

FLX1 Flexible Coupling Dimensions

Figure 1

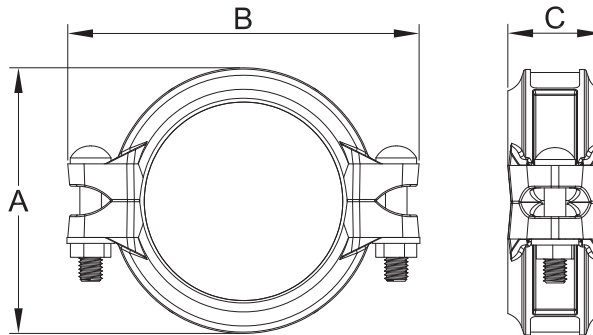

Table A

Nominal Size in (mm)	Pipe O.D. in (mm)	Max. End Load Lbs (KN)	Pipe End Gap in (mm)	Bolts Size x Length	Angular Movement from Centerline		Dimensions			Weight lb (kg)
					Per Coupling Deg.	Per Pipe in/ft (mm/m)	A in (mm)	B in (mm)	C in (mm)	
1 (25)	1.315 (33.7)	405 (1.8)	1/16 (1.6)	M10 x 40	2.75°	0.58 (48)	2-3/16 (55)	3-13/16 (97)	1-3/4 (45)	0.99 (0.45)
1-1/4 (32)	1.660 (42.2)	656 (2.92)	1/16 (1.6)	M10 x 45	2.17°	0.46 (38)	2-1/2 (64)	4-1/4 (108)	1-3/4 (45)	1.10 (0.50)
1-1/2 (40)	1.900 (48.3)	852 (3.79)	1/16 (1.6)	M10 x 55	1.9°	0.4 (33)	2-3/4 (69)	4-1/2 (114)	1-3/4 (45)	1.17 (0.53)
2 (50)	2.375 (60.3)	1327 (5.91)	1/16 (1.6)	M10 x 55	1.52°	0.32 (27)	3-5/16 (84)	4-7/8 (124)	1-13/16 (46)	1.50 (0.68)
2-1/2 (65)	2.875 (73.0)	1945 (8.66)	1/16 (1.6)	M10 x 55	1.25°	(21)	3-7/8 (98)	5-3/8 (137)	1-13/16 (46)	1.85 (0.84)
76 mm	3 (76.1)	2114 (6.41)	1/16 (1.6)	M10 x 55	1.2°	(21)	3-7/8 (98)	5-7/16 (139)	1-13/16 (46)	1.85 (0.84)
3 (80)	3.500 (88.9)	2885 (12.84)	1/16 (1.6)	M10 x 55	1.03°	0.22 (18)	4-1/2 (114)	6-1/8 (156)	1-13/16 (46)	2.16 (0.98)
4 (100)	4.500 (114.3)	4769 (21.22)	1/8 (3.2)	M12 x 65	1.6°	0.34 (28)	5-9/16 (142)	7-7/16 (189)	2 (50)	3.02 (1.37)
139 mm	5.500 (139.7)	7124 (31.7)	1/8 (3.2)	M12 x 65	1.3°	(23)	6-11/16 (170)	8-3/4 (222)	2 (50)	4.07 (1.8)
165 mm	6.500 (165.1)	9950 (44.27)	1/8 (3.2)	M12 x 65	1.1°	(20)	7-3/4 (196)	9-5/8 (244)	2 (50)	4.63 (2.1)
6 (150)	6.625 (168.3)	10340 (46)	1/8 (3.2)	M12 x 65	1.08°	(21)	7-13/16 (198)	9-7/8 (251)	2 (50)	4.63 (2.10)
8 (200)	8.625 (219.1)	17524 (77.97)	1/8 (3.2)	M16 x 80	0.83°	0.18 (15)	10-1/16 (256)	12-7/16 (316)	2-3/8 (60)	8.27 (3.75)
10 (250)	10.750 (273.0)	27206 (121.05)	1/8 (3.2)	M20 x 90	0.83°	0.12 (10)	12-9/16 (319)	15-1/2 (393)	2-1/2 (64)	14.22 (6.45)
12 (300)	12.750 (323.9)	38297 (170.39)	1/8 (3.2)	M20 x 110	0.83°	0.12 (10)	14-3/4 (374)	17-13/16 (453)	2-1/2 (65)	18.95 (8.55)

FLX1 Pipe Compatibility

Table B

Nominal Size in (mm)	Groove Type	Pipe	Approvals
1 (25)	Cut, Rolled	40	cULus, FM
	Rolled	10	FM
1-1/4 (32)	Cut, Rolled	40	cULus, FM
	Rolled	10	cULus, FM
		Mega-Flow Schedule 7	cULus, FM
		Eddy Flow Schedule 7	cULus, FM
1-1/2 (40)	Cut, Rolled	40	cULus, FM
	Rolled	10	cULus, FM
		Fire-Flo Schedule 7	cULus, FM
		Mega-Flow Schedule 7	cULus, FM
		Eddy Flow Schedule 7	cULus, FM
2 (50)	Cut, Rolled	40	cULus, FM
	Rolled	10	cULus, FM
		Fire-Flo Schedule 7	cULus, FM
		Mega-Flow Schedule 7	cULus, FM
		Eddy Flow Schedule 7	cULus, FM
		Hydroflow Schedule 7	cULus, FM
2-1/2 (65)	Cut, Rolled	40	cULus, FM
	Rolled	10	cULus, FM
		Fire-Flo Schedule 7	cULus, FM
		Mega-Flow Schedule 7	cULus, FM
		Eddy Flow Schedule 7	cULus, FM
		Hydroflow Schedule 7	cULus, FM
76.1 mm	Cut, Rolled	40	FM
		ISO 4200 G	FM
		GB / T3091	cULus
	Rolled	30	FM
		10	FM
		ISO 4200 E, F, G	FM
3 (80)	Cut, Rolled	40	cULus, FM
	Rolled	10	cULus, FM
		Fire-Flo Schedule 7	cULus, FM
		Mega-Flow Schedule 7	cULus, FM
		Eddy Flow Schedule 7	cULus, FM
		Hydroflow Schedule 7	cULus, FM

FLX1 Pipe Compatibility (cont.)

Table B

Nominal Size in (mm)	Groove Type	Pipe	Approvals
4 (100)	Cut, Rolled	40	cULus, FM
		10	cULus, FM
	Rolled	Fire-Flo Schedule 7	cULus, FM
		Mega-Flow Schedule 7	cULus, FM
		Eddy Flow Schedule 7	cULus, FM
		Hydroflow Schedule 7	cULus, FM
139.7 mm	Cut, Rolled	40	FM
		GB / T3091	cULus
	Rolled	10	FM
		30	FM
		GB / T3091	FM
165.1 mm	Cut, Rolled	40	FM
		GB / T3092	cULus
	Rolled	30	FM
		10	FM
6 (150)	Cut, Rolled	40	cULus, FM
		10	cULus, FM
	Rolled	Mega-Flow Schedule 7	cULus, FM
8 (200)	Cut, Rolled	40	cULus, FM
		10	cULus
	Rolled	0.188 in. wall	FM
10 (250)	Cut, Rolled	40	cULus, FM
		10	cULus
	Rolled	0.188 in. wall	FM
12 (300)	Cut, Rolled	40	cULus, FM
		ASME B36.10M-10	cULus
	Rolled	0.188 in. wall	FM

Notes:

1. 10 refers to Schedule 10 steel pipe in accordance with NFPA 13.
2. 40 refers to Schedule 40 steel pipe in accordance with NFPA 13.
3. Fire-Flo Schedule 7 refers to Youngstown Tube Schedule 7 pipes.
4. Mega-Flow Schedule 7 refers to Listed Mega-Flow steel Pipe manufactured by Wheatland Tube Co.
5. Eddy Flow Schedule 7 refers to Listed Eddy Flow steel pipe manufactured by Bull Moose Tube Co.
6. Hydroflow Schedule 7 refers to Listed Nucor Hydroflow steel pipe manufactured by Nucor Tubular Products Inc.

P/N 999997068-1